

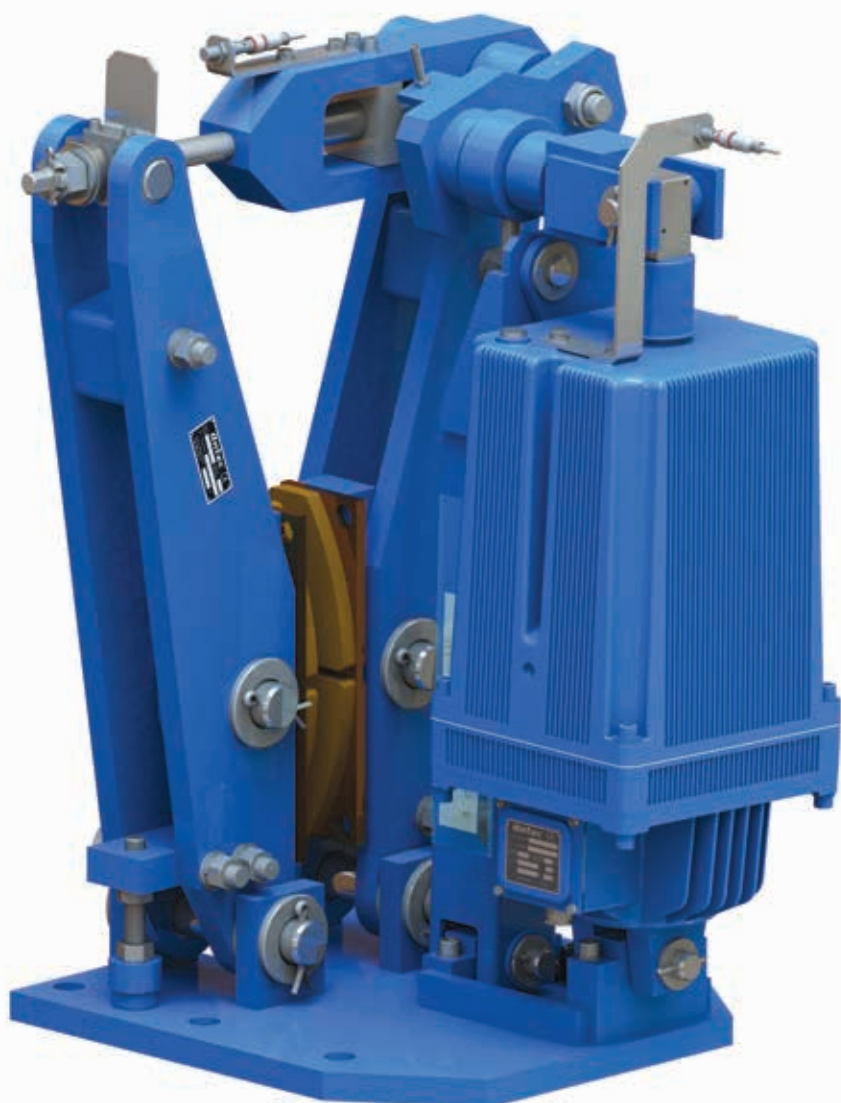

# Electrohydraulic disc brakes

 **antec**®  
*Reliability is a must.*

# GENERAL DESCRIPTION



The FPT, FBT and FDA brakes are spring applied, power released disc brakes. Brake release is achieved by a thruster.

The thruster is a three-phase AC electrohydraulic device.

Brake shoes carry asbestos free linings. The main shafts are made of stainless steel with self-lubricated bushings.

Brakes include torque scale.

Model: FBT-34 TH-III  
(1306) CSA inductive +DD  
inductive +DM +GS



# FPT-1

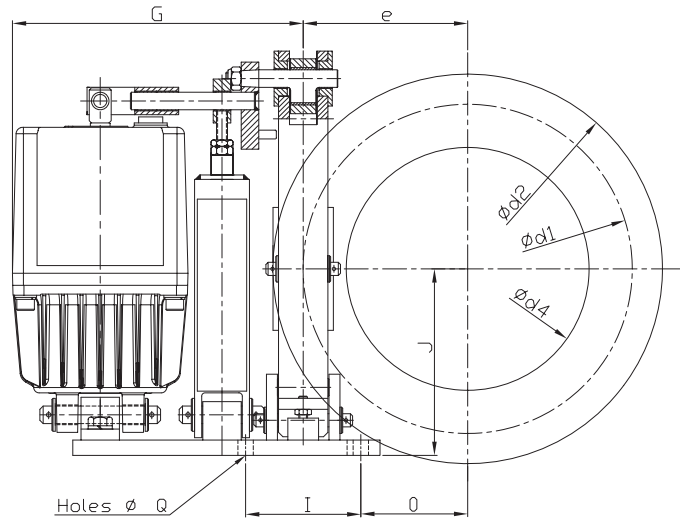
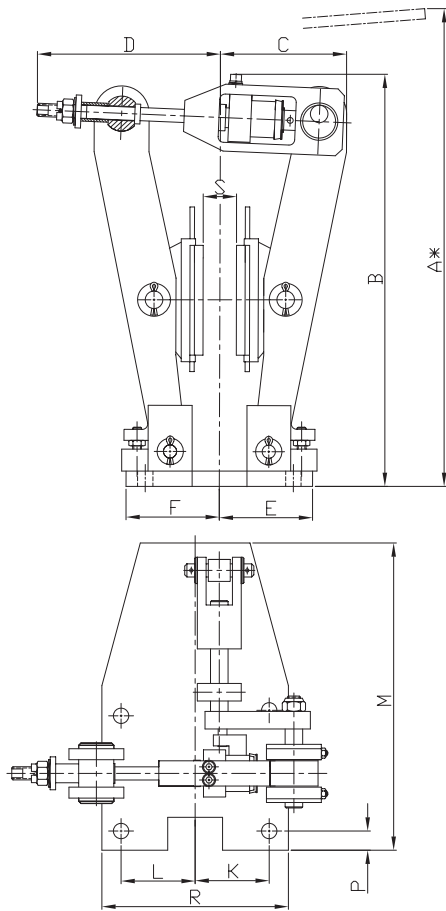

d1 = Theoretical friction diameter (mm).

d2 = Outside diameter (mm).

d4 = Max. allowable coupling or hub diameter (mm).

A\* = Minimum distance required for manual release lever.

| A*               | B   | C   | D   | E     | F   | G    | I                  | K               | L               | M   | P    | Q  | R   | WEIGHT |
|------------------|-----|-----|-----|-------|-----|------|--------------------|-----------------|-----------------|-----|------|----|-----|--------|
| 400              | 380 | 120 | 170 | 85    | 85  | 265  | 105                | 67.5            | 67.5            | 280 | 17.5 | 14 | 170 | 28 kg  |
| Disc information |     |     |     |       |     |      | THRUSTOR type      |                 |                 |     |      |    |     |        |
| d2               | S   | d1  | d4  | e     | J   | O    | Clamping Force (N) | TH-I (256)      |                 |     |      |    |     |        |
|                  |     |     |     |       |     |      |                    | Min Torque (Nm) | Max Torque (Nm) |     |      |    |     |        |
| 200              | 30  | 145 | 55  | 72.5  | 170 | 20   |                    | 3300            | 95              | 190 |      |    |     |        |
| 240              | 30  | 185 | 95  | 92.5  | 170 | 40   |                    |                 | 120             | 240 |      |    |     |        |
| 280              | 30  | 225 | 135 | 112.5 | 170 | 60   |                    |                 | 147.5           | 295 |      |    |     |        |
| 315              | 30  | 260 | 170 | 130   | 170 | 77.5 |                    |                 | 170             | 340 |      |    |     |        |
| 355              | 30  | 300 | 210 | 150   | 170 | 97.5 |                    |                 | 197.5           | 395 |      |    |     |        |
| 400              | 30  | 345 | 255 | 172.5 | 170 | 120  | 227.5              |                 | 455             |     |      |    |     |        |

Friction coefficient  $\mu=0,4$ . Dimension values are in mm.

# FBT-21

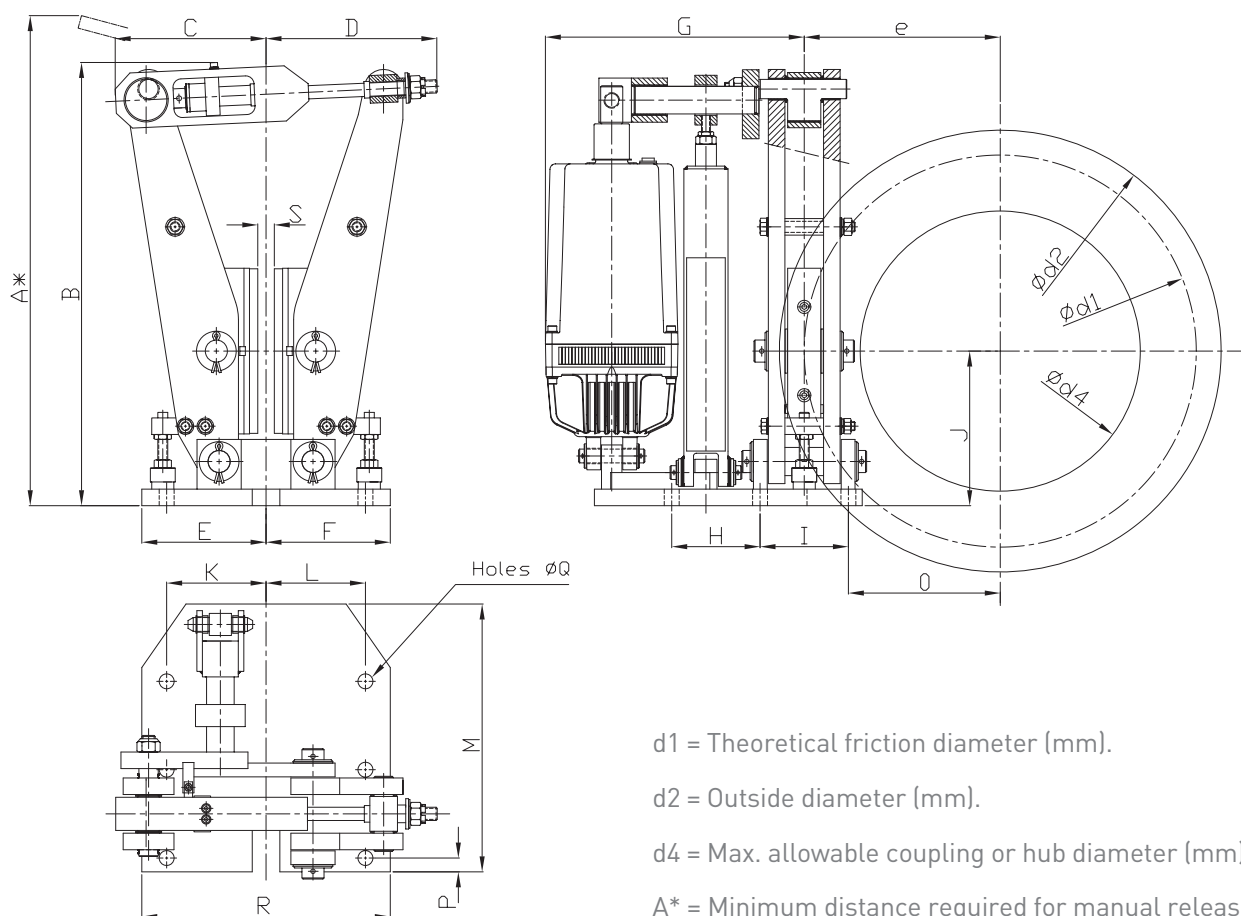

d1 = Theoretical friction diameter (mm).  
 d2 = Outside diameter (mm).  
 d4 = Max. allowable coupling or hub diameter (mm).  
 A\* = Minimum distance required for manual release lever.

| A*               | B   | C   | D   | E     | F   | G    | H                  | I               | K               | L                  | M               | P               | Q                  | R               | WEIGHT          |
|------------------|-----|-----|-----|-------|-----|------|--------------------|-----------------|-----------------|--------------------|-----------------|-----------------|--------------------|-----------------|-----------------|
| 800              | 565 | 182 | 205 | 170   | 170 | 340  | 130                | 130             | 145             | 145                | 365             | 25              | 22                 | 340             | 76 - 83 kg      |
| Disc information |     |     |     |       |     |      | THRUSTOR type      |                 |                 |                    |                 |                 |                    |                 |                 |
| d2               | S   | d1  | d4  | e     | J   | O    | Clamping Force (N) | TH-I (356)      |                 | TH-II (506)        |                 | TH-II (806)     |                    |                 |                 |
|                  |     |     |     |       |     |      |                    | Min Torque (Nm) | Max Torque (Nm) | Clamping Force (N) | Min Torque (Nm) | Max Torque (Nm) | Clamping Force (N) | Min Torque (Nm) | Max Torque (Nm) |
| 355              | 30  | 285 | 170 | 142.5 | 230 | 77.5 | 5600               | 315             | 630             | 7800               | 442.5           | 885             | 13300              | 750             | 1500            |
| 400              | 30  | 330 | 210 | 165   | 230 | 100  |                    | 365             | 730             |                    | 510             | 1020            |                    | 875             | 1750            |
| 450              | 30  | 380 | 260 | 190   | 230 | 125  |                    | 422.5           | 845             |                    | 590             | 1180            |                    | 1007.5          | 2015            |
| 500              | 30  | 430 | 310 | 215   | 230 | 150  |                    | 477.5           | 955             |                    | 667.5           | 1335            |                    | 1140            | 2280            |
| 560              | 30  | 490 | 370 | 245   | 230 | 180  |                    | 545             | 1090            |                    | 762.5           | 1525            |                    | 1300            | 2600            |
| 630              | 30  | 560 | 440 | 280   | 230 | 215  |                    | 622.5           | 1245            |                    | 870             | 1740            |                    | 1485            | 2970            |
| 710              | 30  | 640 | 520 | 320   | 230 | 255  |                    | 715             | 1430            |                    | 998.5           | 1997            |                    | 1702.5          | 3405            |
| 800              | 30  | 730 | 610 | 365   | 230 | 300  | 817.5              | 1635            | 1139            | 2278               | 1942            | 3884            |                    |                 |                 |

Friction coefficient  $\mu=0,4$ . Dimension values are in mm.

# FBT - 34

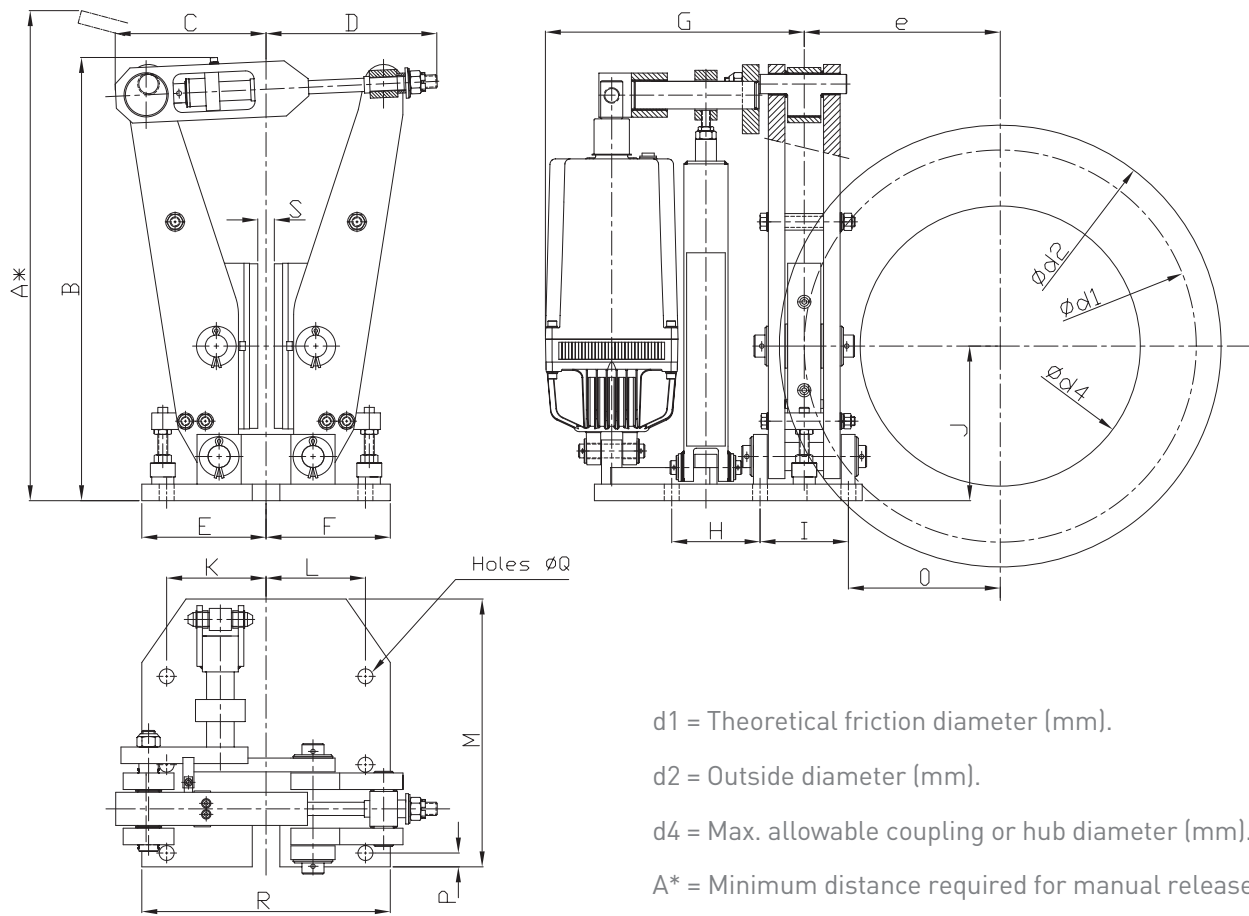

d1 = Theoretical friction diameter (mm).  
 d2 = Outside diameter (mm).  
 d4 = Max. allowable coupling or hub diameter (mm).  
 A\* = Minimum distance required for manual release lever.

| A*               | B   | C    | D   | E   | F   | G   | H                  | I                                                  | K     | L                  | M                                                  | P     | Q                  | R                                                  | WEIGHT |
|------------------|-----|------|-----|-----|-----|-----|--------------------|----------------------------------------------------|-------|--------------------|----------------------------------------------------|-------|--------------------|----------------------------------------------------|--------|
| 1130             | 830 | 275  | 310 | 225 | 225 | 475 | 160                | 160                                                | 180   | 180                | 485                                                | 25    | 27                 | 450                                                | 234 kg |
| Disc information |     |      |     |     |     |     | THRUSTOR type      |                                                    |       |                    |                                                    |       |                    |                                                    |        |
| d2               | S   | d1   | d4  | e   | J   | O   | Clamping Force (N) | TH-III (1306)<br>Min Torque (Nm)   Max Torque (Nm) |       | Clamping Force (N) | TH-III (2006)<br>Min Torque (Nm)   Max Torque (Nm) |       | Clamping Force (N) | TH-III (3006)<br>Min Torque (Nm)   Max Torque (Nm) |        |
| 450              | 30  | 350  | 170 | 175 | 280 | 95  |                    | 1490                                               | 2980  |                    | 2288                                               | 4575  |                    | 3490                                               | 6980   |
| 500              | 30  | 400  | 220 | 200 | 280 | 120 |                    | 1695                                               | 3390  |                    | 2600                                               | 5200  |                    | 3975                                               | 7950   |
| 560              | 30  | 460  | 280 | 230 | 280 | 150 |                    | 1945                                               | 3890  |                    | 2988                                               | 5975  |                    | 4560                                               | 9120   |
| 630              | 30  | 530  | 350 | 265 | 280 | 185 |                    | 2235                                               | 4470  |                    | 3430                                               | 6860  |                    | 5225                                               | 10450  |
| 710              | 30  | 610  | 430 | 305 | 280 | 225 | 20700              | 2565                                               | 5130  | 31500              | 3940                                               | 7880  | 46000              | 6000                                               | 12000  |
| 800              | 30  | 700  | 520 | 350 | 280 | 270 |                    | 2938                                               | 5875  |                    | 4515                                               | 9030  |                    | 6850                                               | 13700  |
| 900              | 30  | 800  | 620 | 400 | 280 | 320 |                    | 3312                                               | 6624  |                    | 5040                                               | 10080 |                    | 7850                                               | 15700  |
| 1000             | 30  | 900  | 720 | 450 | 280 | 370 |                    | 3726                                               | 7452  |                    | 5670                                               | 11340 |                    | 8800                                               | 17600  |
| 1250             | 30  | 1150 | 970 | 575 | 280 | 495 |                    | 5175                                               | 10350 |                    | 7875                                               | 15750 |                    | 11500                                              | 23000  |

Friction coefficient  $\mu=0,4$ . Dimension values are in mm.

# FDA-92

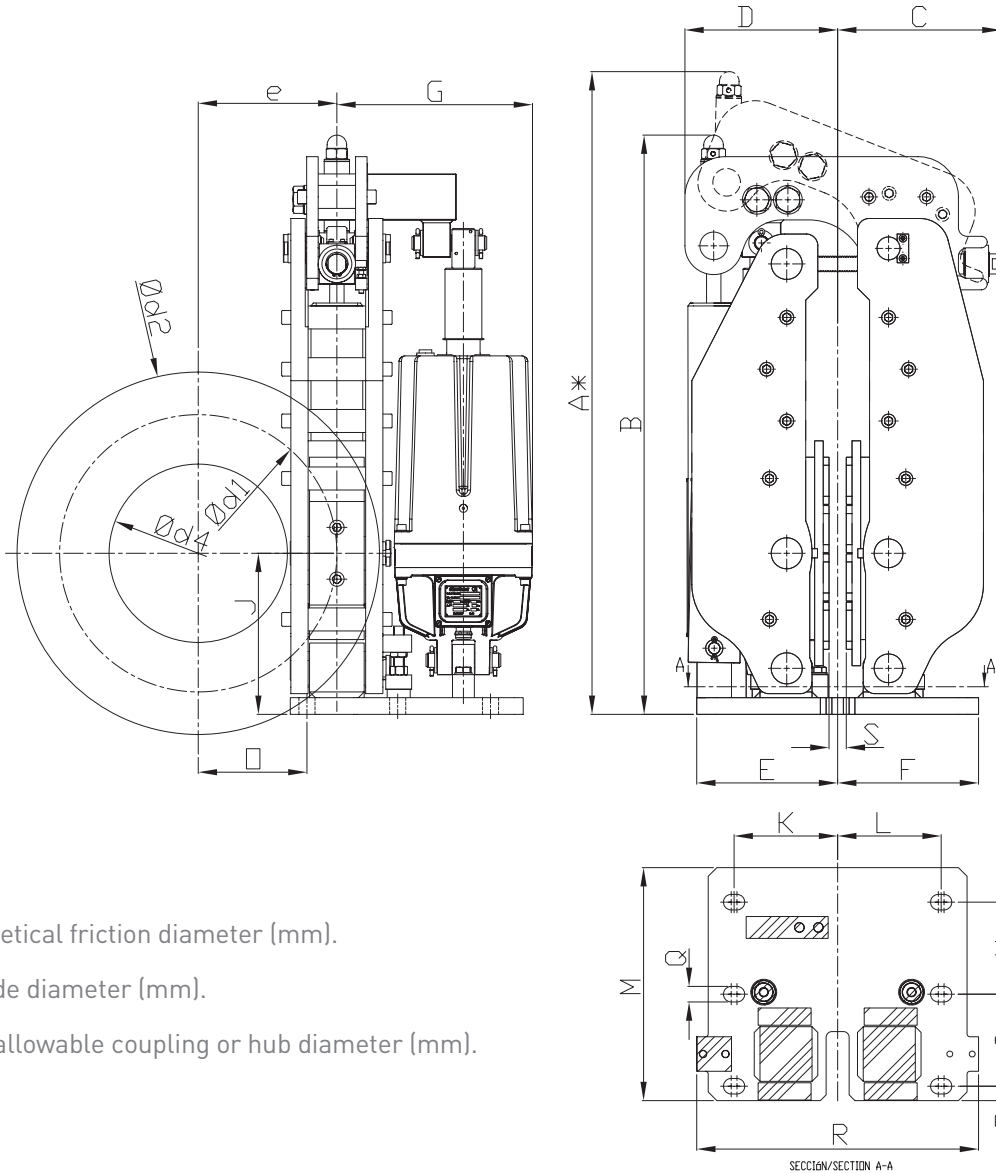

- d1 = Theoretical friction diameter (mm).
- d2 = Outside diameter (mm).
- d4 = Max. allowable coupling or hub diameter (mm).

| A*               | B    | C    | D   | E     | F     | G   | H                  | I   | K   | L               | M               | P  | Q  | R   | WEIGHT |
|------------------|------|------|-----|-------|-------|-----|--------------------|-----|-----|-----------------|-----------------|----|----|-----|--------|
| 1117             | 1007 | 284  | 298 | 253.5 | 253.5 | 340 | 160                | 160 | 180 | 180             | 405             | 25 | 27 | 490 | 400 kg |
| Disc information |      |      |     |       |       |     | THRUSTOR type      |     |     |                 |                 |    |    |     |        |
| d2               | S    | d1   | d4  | e     | J     | O   | Clamping Force (N) |     |     | TH-III (4010)   |                 |    |    |     |        |
|                  |      |      |     |       |       |     | 92000              |     |     | Min Torque (Nm) | Max Torque (Nm) |    |    |     |        |
| 630              | 30   | 482  | 310 | 241   | 280   | 185 |                    |     |     | 8869            | 17738           |    |    |     |        |
| 710              | 30   | 562  | 390 | 281   | 280   | 225 |                    |     |     | 10341           | 20682           |    |    |     |        |
| 800              | 30   | 652  | 480 | 326   | 280   | 270 |                    |     |     | 11997           | 23994           |    |    |     |        |
| 900              | 30   | 752  | 580 | 376   | 280   | 320 |                    |     |     | 13837           | 27674           |    |    |     |        |
| 1000             | 30   | 852  | 680 | 426   | 280   | 370 |                    |     |     | 15677           | 31354           |    |    |     |        |
| 1250             | 30   | 1102 | 930 | 551   | 280   | 495 |                    |     |     | 20277           | 40554           |    |    |     |        |

Friction coefficient  $\mu=0,4$ . Dimension values are in mm.

## OPTIONS

1. Automatic lining wear adjustment (RA).
2. Mechanical or inductive open brake switch indicator (CSA).
3. Standard or inductive lining wear indicator (DD).
4. Hand release lever (DM).
5. Descent valve (VD).
6. Special paint (PE).
7. Hydraulic or pneumatic release.
8. ATEX certificated thrustor.
9. Special bolts (stainless steel, galvanized).
10. Thrustor's stroke linear detector (DL).
11. Sintered metal linings.

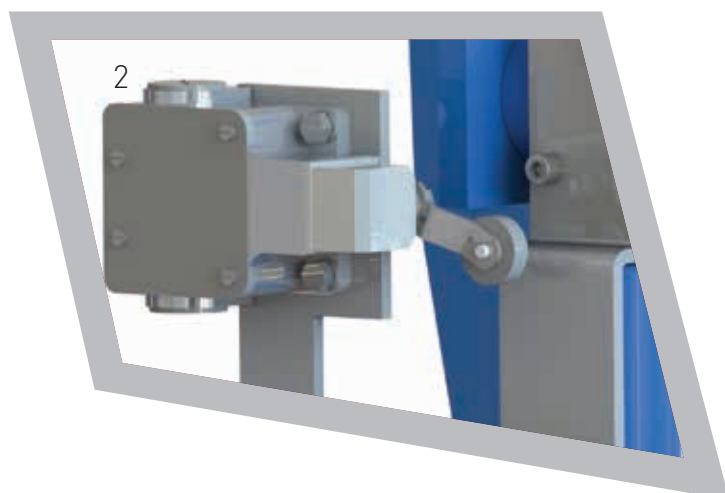
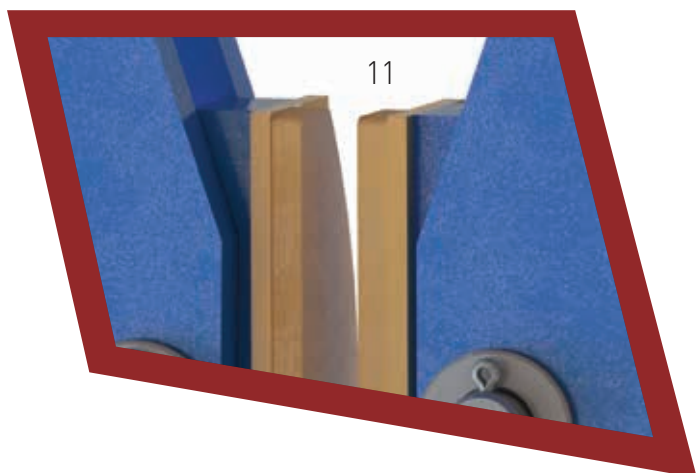
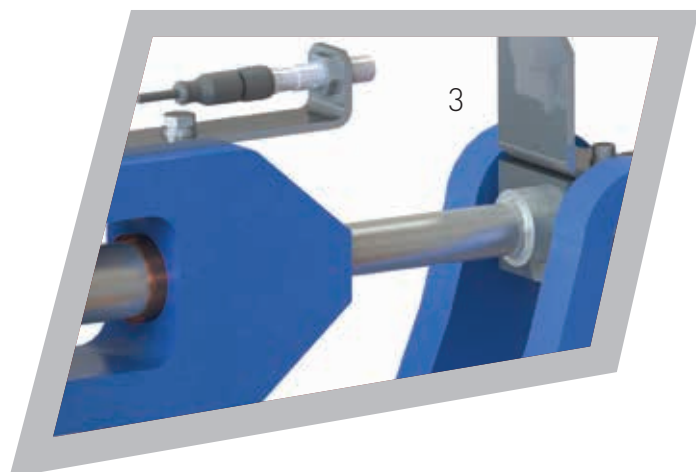
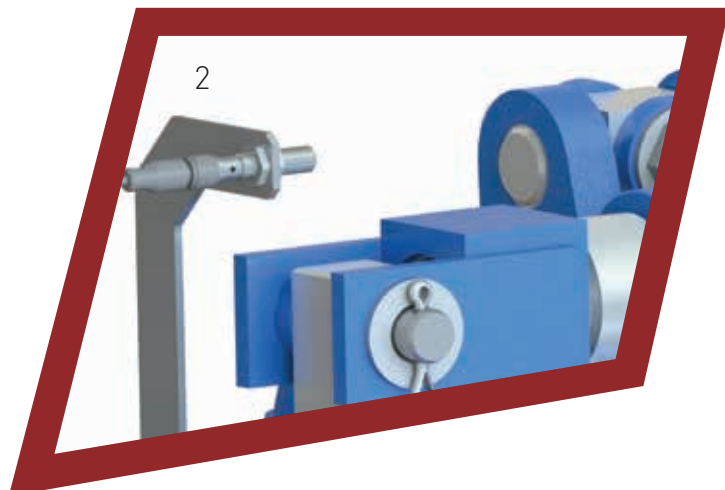
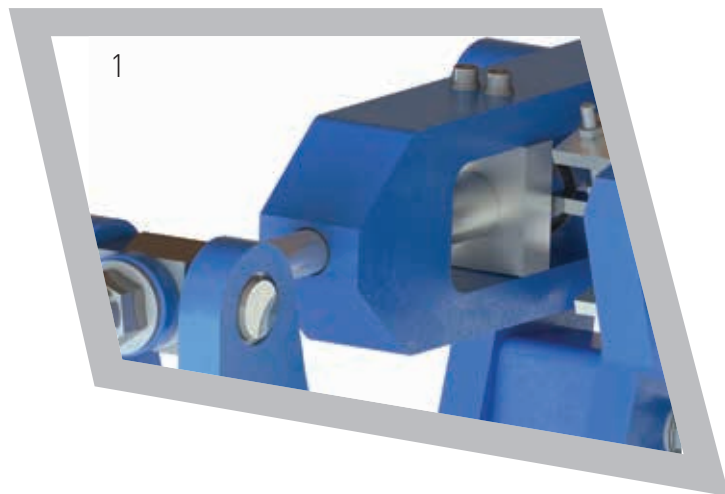

For further information about options, please contact ANTEC's Sales Service.



#### **ANTEC SPAIN (Headquarters)**

Aplicación Nuevas Tecnologías Antec SAU.

Ramón y Cajal, 74. 48920.  
Portugalete. (Vizcaya) SPAIN

Tel.: (34) 94.496.50.11  
Fax: (34) 94.496.53.37

sales@antecsa.com  
**antec-group.com**

#### **ANTEC CHINA**

Antec Braking Systems Co. Ltd.

No.4, Longhuai Road,  
Shuangjiang Dao South  
Beichen Development Area  
300400 Tianjin, CHINA.

Tel.: +86 22 26983272  
Fax: +86 22 26983273

info@antec-bs.com  
**antec-group.com**

#### **ANTEC BRAZIL**

Antec Eolica Fabricação e Comercio  
de Frios Ltda.

Rua do Bronze (Antiga Rua H) S/N,  
Quadra 43, Lote 080,  
Polo de Apoio Camaçari,  
Bahia CEP: 42801-170, BRAZIL.

Tel.: +55 (71) 36.22.93.16

info@anteceolica.com  
**antec-group.com**