



Industrial **brakes**

Electrohydraulic Drum Brakes

 **antec**®
Reliability is a must.

GENERAL DESCRIPTION

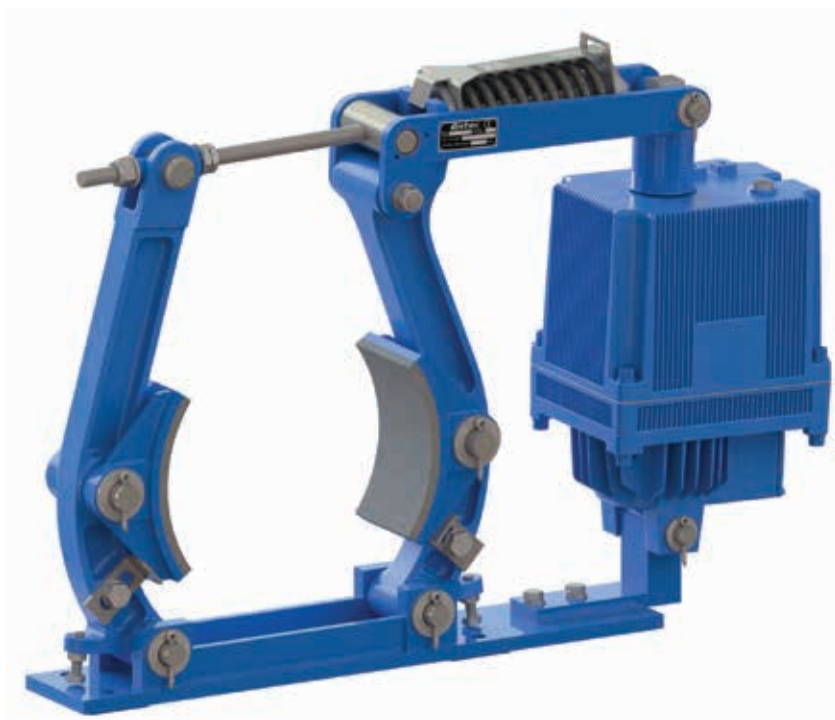

Model: NDT-315 TH-II (806)

The NDT, NFT, NAT, NDTV and NDTA brakes are spring applied power released drum brakes. The brake release is achieved by a thruster. The thruster is a three-phase AC electrohydraulic device.

All the brakes include a visual control scale for an easy torque adjustment.

Asbestos free linings.

Brakes are supplied according to the following standards.

STANDARDS	AISE N°11	DIN 15.435	S-472A
ANTEC brake models	NAT	NDT NDT-V NDT-A	NFT



NDT BRAKES (DIN 15.435)

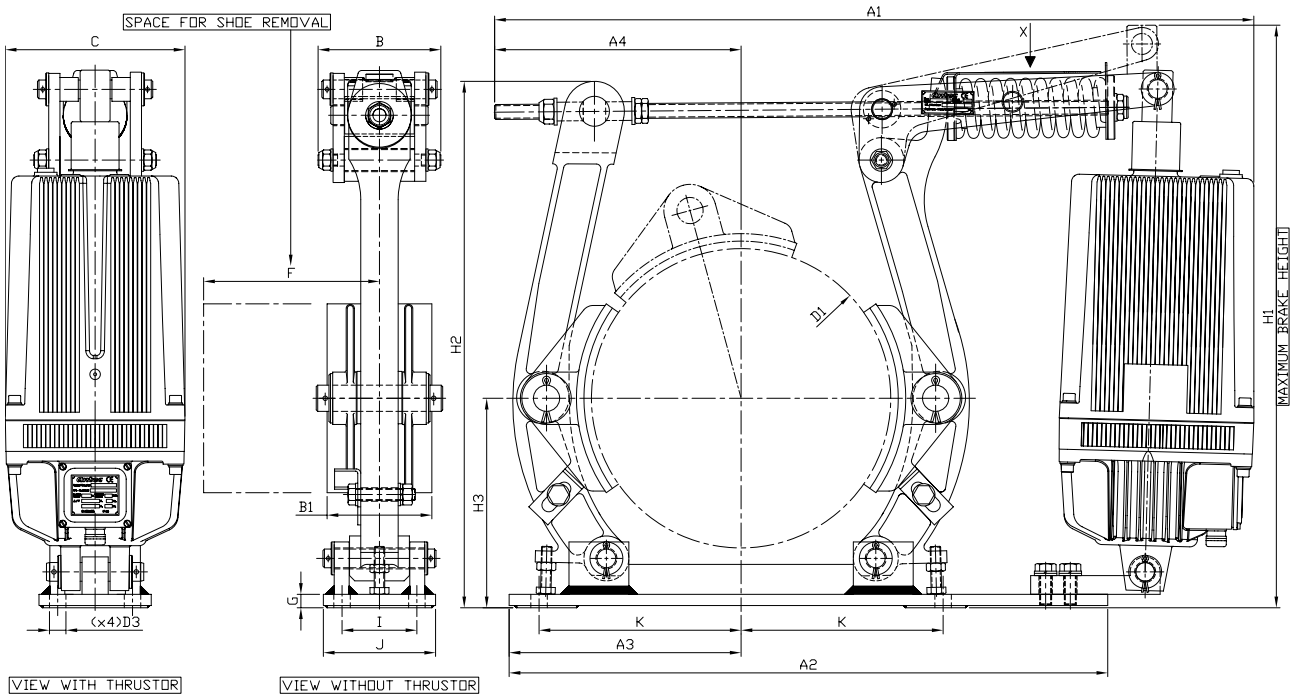

BRAKE TYPE	THRUSTOR TYPE	TORQUE (Nm)		WEIGHT (Kg)	DRUM WIDTH	SHOE WIDTH		DIMENSIONS															
		min.	max.			B2	B1	D1	D3	H3	I	K	A1	A2	A3	A4	B	C	F	G	H1	H2	J
160	I-256	130	260	23	80	65	160	11	125	55	108	576	410	130	203	85	160	70	20	411	295	80	
200	I-256	158	315	29	75	70	200	14	160	55	145	674	510	185	197	116	160	125	19	414	355	90	
	I-356	208	415	34								686			202					497			
250	I-256	180	360	35	95	90	250	18	190	65	180	688	580	220	201	116	160	130	13	430	413	100	
	I-356	285	570	40								745			205					500			
315	I-356	375	750	59	118	110	315	18	230	80	220	770	800	690	260	226	160	195	180	18	600	588	120
	II-506	725	1450	62								842				229					633		
	II-806	1450	2100	63								842				229					633		
400	II-506	800	1600	85	150	140	400	22	280	100	270	976	800	310	295	165	195	210	18	716	704	150	
	III-1306	1950	3900	107								1015			329					779			
	II-806	1150	2300	125								1065			337					825			
500	III-1306	1750	3500	145	190	180	500	22	340	130	325	1050	940	365	334	190	240	250	23	825	803	180	
	III-2006	2850	5700	147								1070			334					845			
	III-1306	2150	4300	240								1214			410					960			
630	III-2006	-	-	242	236	225	630	27	420	170	400	1251	1150	460	450	230	240	305	23	965	940	220	
	III-3006	5800	9000	244								1231			430					980			
	III-3012	-	-	258								1363			440					970			
	III-2006	4100	8200	323								1353											
710	III-3006	5200	10400	324	265	255	710	27	470	190	450	1353	1280	510	468	250	240	340	27	1082	1061	250	
	III-3012	-	-	338								1491											

Friction coefficient $\mu=0,4$. Dimension values are in mm.

NDT-V BRAKES (DIN 15.435)

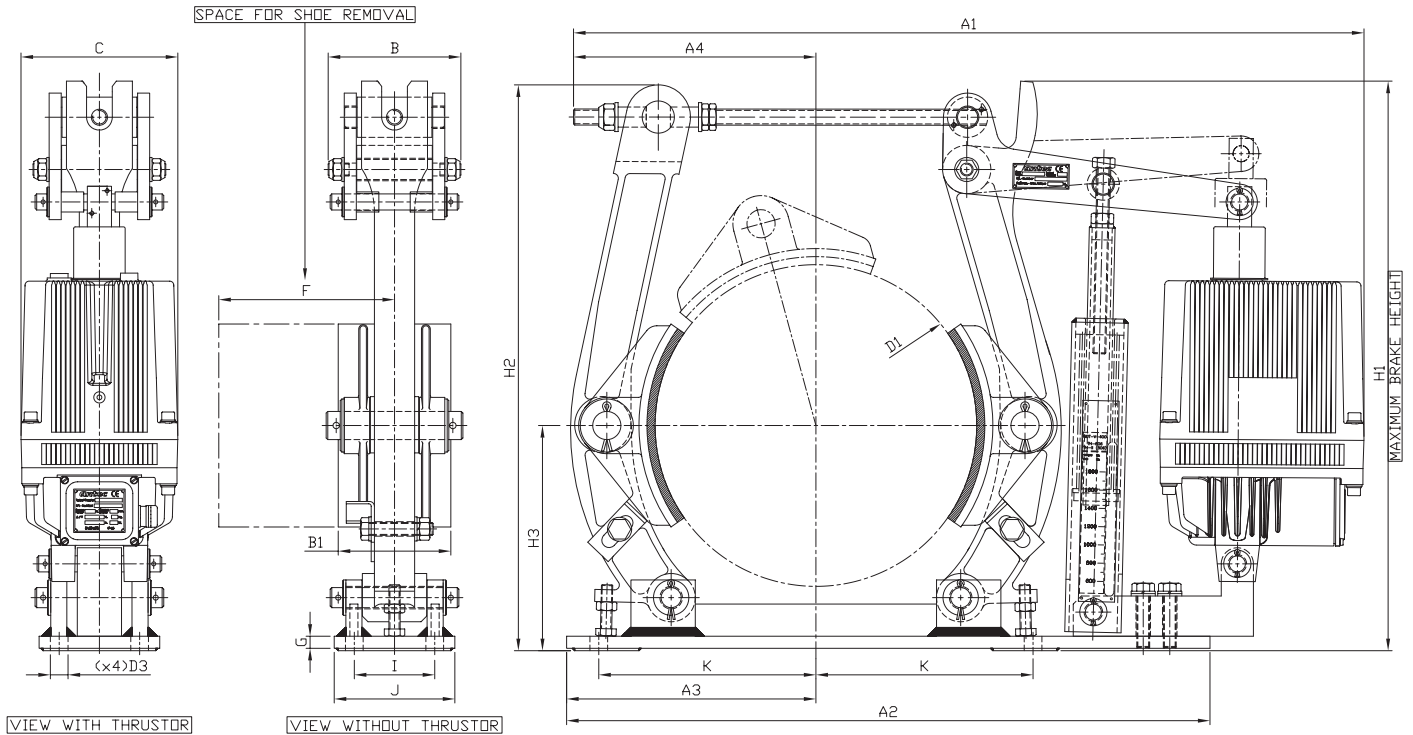

BRAKE TYPE	THRUSTOR TYPE	TORQUE (Nm)		WEIGHT (Kg)	DRUM WIDTH	SHOE WIDTH	DIMENSIONS															
		min.	max.				B2	B1	D1	D3	H3	I	K	A1	A2	A3	A4	B	C	F	G	H1
160	I-256	140	350	33	70	65	160	11	130	55	120	570	335	140	135	115	160	75	10	391	296	90
	I-356	225	325	29	75	70	200	14	160	55	145	655	510	185	178	116	160	125	19	413	355	90
200	I-256	230	430	34	75	70	200	14	160	55	145	661	510	185	178	116	160	125	19	413	355	90
	I-356	220	340	35	95	90	250	18	190	65	180	690	580	220	204	116	160	130	13	423	413	100
250	I-256	240	540	40	95	90	250	18	190	65	180	745	580	220	204	116	160	130	13	423	413	100
	I-356	460	710	59	118	110	315	18	230	80	220	765	690	260	223	160	195	180	18	593	588	120
315	II-506	620	1320	62	118	110	315	18	230	80	220	805	690	260	223	160	195	180	18	620	588	120
	II-806	1140	1740	63	118	110	315	18	230	80	220	803	690	260	223	160	195	180	18	635	588	120
400	II-506	690	1490	85	150	140	400	22	280	100	270	983	800	310	301	165	195	210	18	708	704	150
	III-1306	1120	2020	87	150	140	400	22	280	100	270	987	800	310	301	165	195	210	18	708	704	150
500	II-806	1975	3575	107	150	140	400	22	280	100	270	987	800	310	301	165	195	210	18	708	704	150
	III-1306	1200	2200	125	190	180	500	22	340	130	325	1039	940	365	312	195	240	250	23	816	803	180
630	III-1306	2600	3480	145	190	180	500	22	340	130	325	1060	940	365	312	195	240	250	23	816	803	180
	III-2006	3200	5250	147	190	180	500	22	340	130	325	1060	940	365	312	195	240	250	23	816	803	180
710	III-1306	2500	3960	240	236	225	630	27	420	170	400	1240	1150	460	435	230	240	305	23	955	940	220
	III-2006	2325	6150	242	236	225	630	27	420	170	400	1240	1150	460	435	230	240	305	23	955	940	220
800	III-3006	6600	8200	244	236	225	630	27	420	170	400	1240	1150	460	435	230	240	305	23	955	940	220
	III-3012	-	-	258	300	290	800	33	520	210	505	1315	1375	575	427	250	240	370	59	1135	1095	290
800	III-2006	2875	7000	323	300	290	800	33	520	210	505	1403	1375	575	427	250	240	370	59	1135	1095	290
	III-3006	5100	9800	324	300	290	800	33	520	210	505	1403	1375	575	427	250	240	370	59	1135	1095	290
800	III-3012	-	-	338	300	290	800	33	520	210	505	1570	1375	575	427	250	240	370	59	1135	1095	290
	III-3012	-	-	364	300	290	800	33	520	210	505	1540	1375	575	427	250	240	370	59	1135	1095	290

Friction coefficient $\mu=0,4$. Dimension values are in mm.

NDT-V BRAKES – HIGH TORQUE MODELS (DIN 15.435)

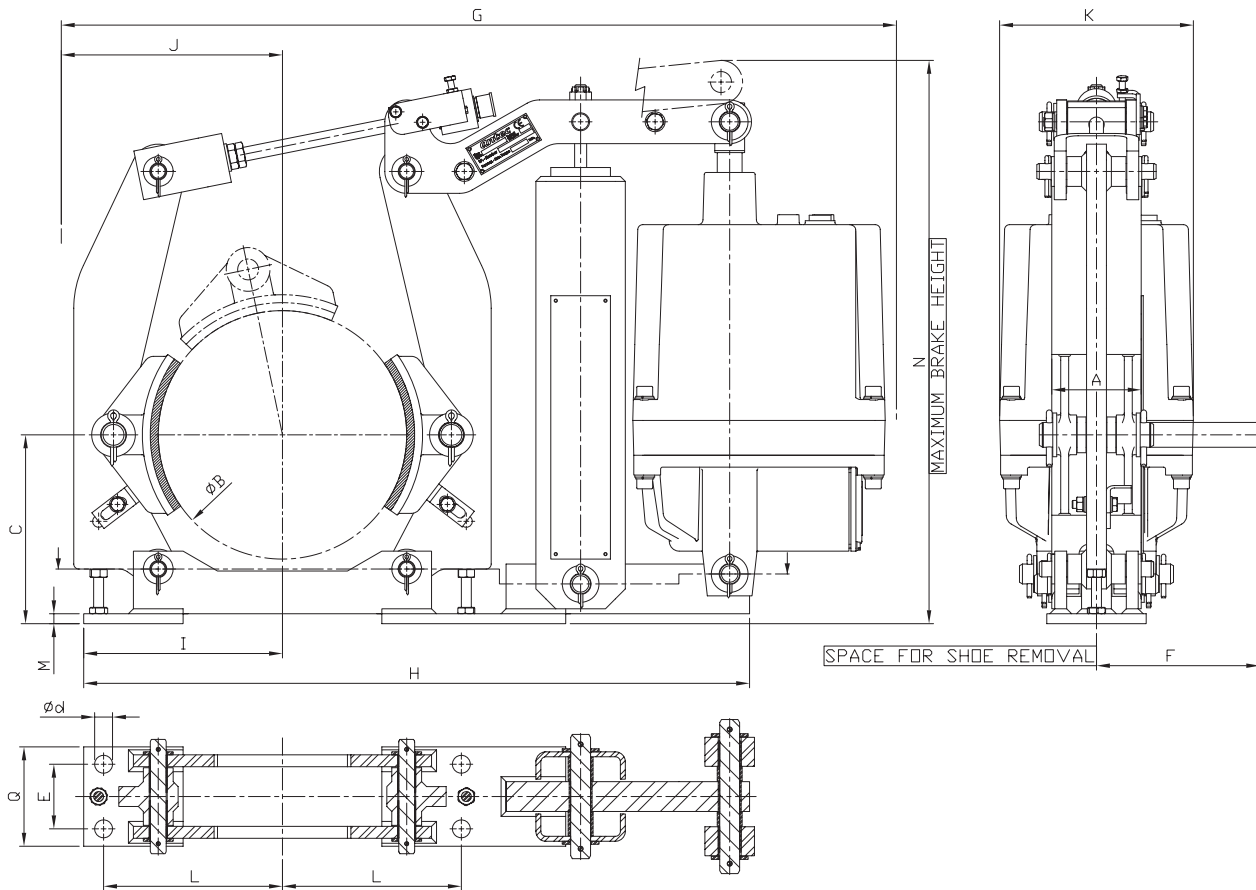

BRAKE TYPE	THRUSTOR TYPE	TORQUE (Nm)		WEIGHT (Kg)	DRUM WIDTH	SHOE WIDTH	DIMENSIONS													
		min.	max.				-	A	B	C	d	E	F	G	H	I	J	K	L	M
NDTV-250	TH-III(506)	490	1490	64	95	90	250	190	18	65	125	817	670	200	210	195	180	10	564	100
NDTV-315	TH-III(806)	650	2580	95	118	110	315	230	18	80	150	944	790	243	260	195	220	18	675	110
NDTV-400	TH-III(1306)	2000	4550	149	150	140	400	280	22	100	185	1010	890	300	305	240	270	18	795	140

Friction coefficient $\mu=0,4$. Dimension values are in mm.

NDT-A BRAKES (DIN 15.435)

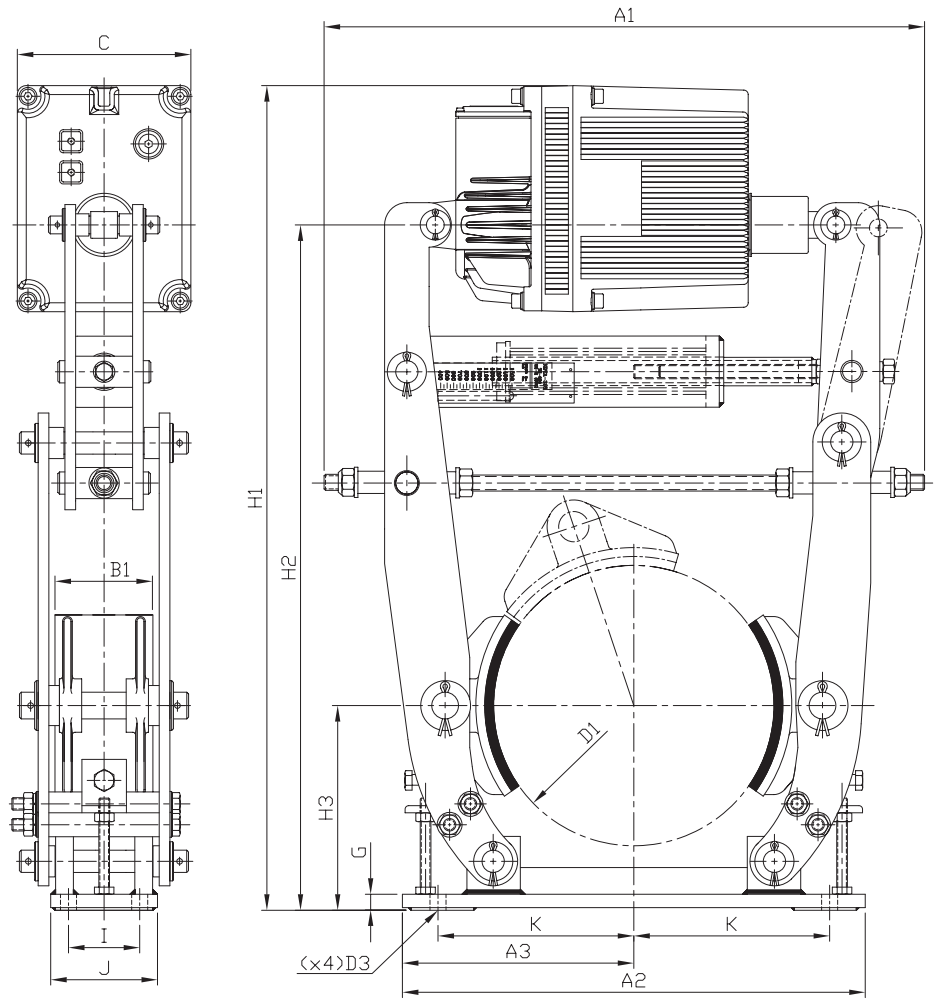

BRAKE TYPE	THRUSTOR TYPE	TORQUE (Nm)		WEIGHT (Kg)	DRUM WIDTH		SHOE WIDTH		DIMENSIONS											
		min.	max.		B2	B1	D1	D3	H3	I	K	A1	A2	A3	A4	C	G	H1	H2	J
160	I-256	60	150	30	80	65	160	11	125	55	108	445	275	137.5	218	160	10	548	428	80
	I-356	90	230	30	75	70	200	14	160	55	145	487	370	185	250	160	19	638	518	90
200	I-256	110	330	36								548			272					
	I-356	90	290	37	95	90	250	18	190	65	180	545	440	220	277	160	13	756	638	100
250	I-356	230	570	62												160		890		
	II-506	310	780	65	118	110	315	18	230	80	220	675	520	260	348	195	18	927	770	120
315	II-806	500	1300	66												195		927		
	II-506	350	870	89												195		1063		
400	II-806	580	1450	91	150	140	400	22	280	100	270	870	620	310	443	195	18	1063	906	150
	III-1306	950	2450	112												240		1040		
500	II-506	450	1150	131												195		1180		
	II-806	700	1750	152	190	180	500	22	340	130	325	850	730	365	445	195	23	1180	1050	180
	III-1306	1200	3000	154												240		1190		
	III-2006	1800	4700	252												240		1190		

Friction coefficient $\mu=0,4$. Dimension values are in mm.

NAT BRAKES (AISE N°11)

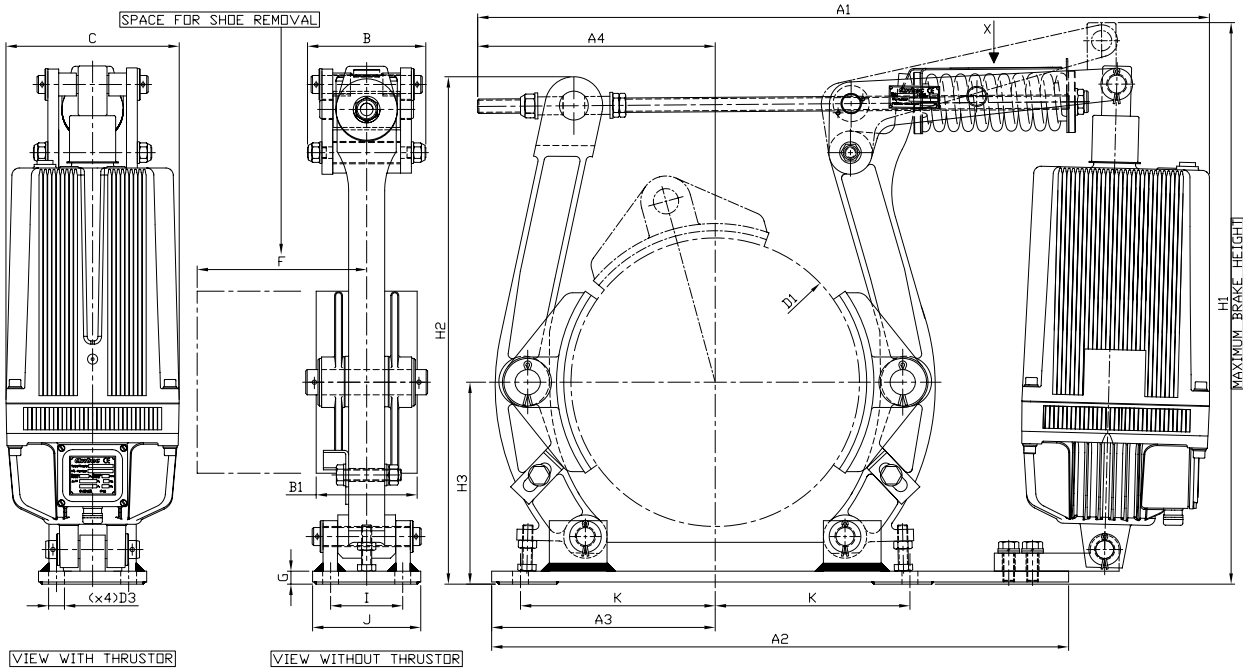

BRAKE TYPE	THRUSTOR TYPE	TORQUE (lb/ft)		WEIGHT (lb)	DRUM WIDTH	SHOE WIDTH		DIMENSIONS														
		min.	max.			B2	B1	D1	D3	H3	I	K	A1	A2	A3	A4	B	C	F	G	H1	H2
6" (152)	I-256	85	170	53	2.75	2.1	6.0	0.4	4.7	3.0	4.0	22.7	16.9	5.4	7.9	3.3	6.3	3.9	0.6	16.0	13.6	3.9
	I-256	122	243	71								26.6	20.1	7.3	7.6	4.6	6.3	4.9	0.7	16.7	14.7	7.5
8" (203)	I-356	159	317	82	3.25	3.0	8.0	0.7	7.0	5.7	3.2	27.0	20.1	7.3	7.6	4.6	6.3	4.9	0.7	20.0	14.7	7.5
	I-256	129	258	84	3.75	3.5	10.0	0.7	8.4	6.3	4.0	28.0	22.8	8.7	8.7	4.6	6.3	5.1	0.7	17.6	17.2	7.9
10" (254)	I-356	199	398	95								30.4	22.8	8.7	8.9	4.6	6.3	5.1	0.7	20.3	17.2	7.9
	I-356	299	597	139								32.0	22.8	8.7	9.6	6.3				24.3		
13" (330)	II-506	572	1143	146	5.75	5.5	13.0	0.8	9.9	9.0	5.7	34.0	27.2	10.2	10.0	6.3	7.7	7.1	1.1	25.4	24.2	11.0
	II-806	1069	1696	148								34.9	27.2	10.2	9.8	7.7				25.9		
16" (406)	II-506	590	1180	198								39.4	27.2	10.2	12.4	7.7				28.9		
	II-806	848	1696	205	6.75	6.5	16.0	1.1	12.1	10.7	7.5	39.4	31.5	12.2	11.6	6.5	7.7	8.3	1.3	28.9	28.7	13.0
19" (482)	III-1306	1401	2803	251								39.8	31.5	12.2	12.6	9.4				31.9		
	II-806	848	1696	295								42.7	31.5	12.2	14.0	7.7				32.2		
23" (584)	III-1306	1254	2508	342	8.75	8.5	19.0	1.1	13.2	13.0	9.3	42.2	37.0	14.4	14.0	7.5	9.4	9.4	1.2	32.2	31.7	15.4
	III-2006	2028	4057	346								44.8	37.0	14.4	15.9	9.4				32.5		
30" (762)	III-1306	1512	3024	540								47.9	37.0	14.4	16.9					37.4		
	III-2006	4278	4794	545	11.25	11.0	23.0	1.3	15.9	16.0	11.7	49.5	45.3	18.1	18.5	9.1	9.4	11.4	1.0	37.4	36.8	18.9
30" (762)	III-3006	4278	6343	551								47.3	45.3	18.1	16.3					37.5		
	III-3012	-	-	584								54.3	45.3	18.1	18.1					37.8		
30" (762)	III-2006	3208	6417	732								56.3	50.4	20.1	20.5							
	III-3006	4149	8298	734	14.25	14.0	30.0	1.6	20.7	19.0	15.0	55.1	50.4	20.1	19.3	9.8	9.4	13.0	1.9	44.9	44.1	22.0
	III-3012	-	-	765								60.6	50.4	20.1	19.3							

Friction coefficient $\mu=0,4$. Dimensions are in inches.

NFT BRAKES (S-472A)

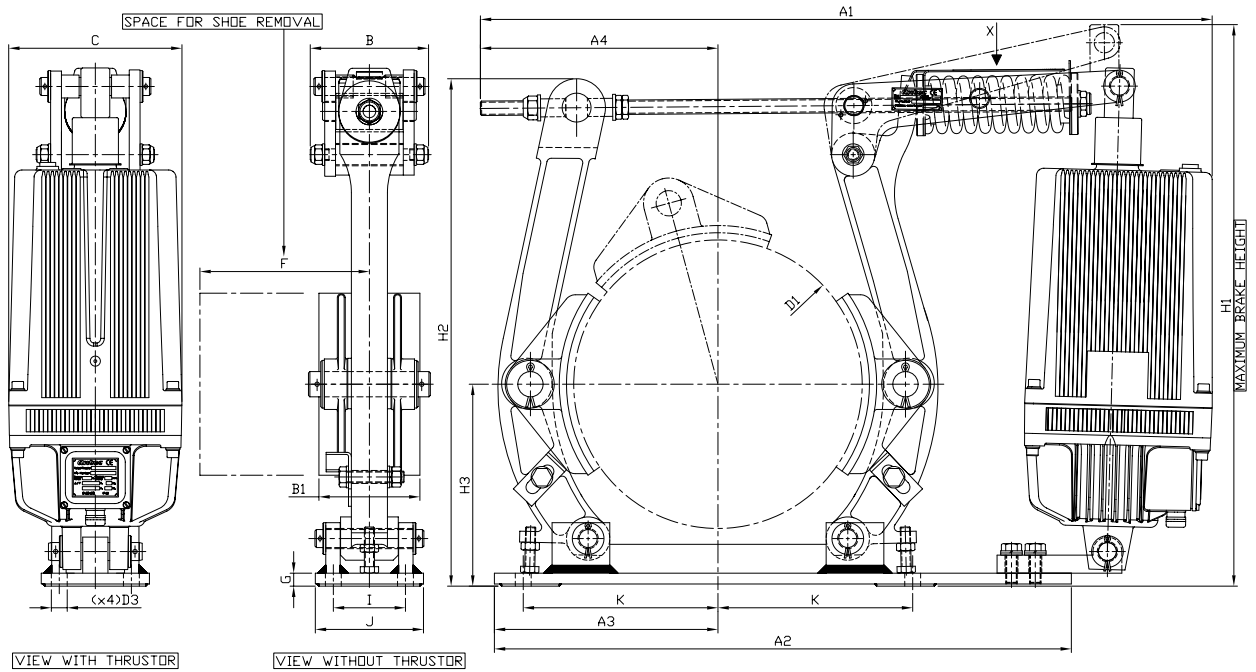

BRAKE TYPE	THRUSTOR TYPE	TORQUE (Nm)		WEIGHT (Kg)	DRUM WIDTH	SHOE WIDTH	DIMENSIONS															
		min.	max.				B2	B1	D1	D3	H3	I	K	A1	A2	A3	A4	B	C	F	G	H1
150	I-256	115	230	24	80	65	150	11	125	135	90	577	400	120	201	85	160	70	10	411	296	160
200	I-256	165	330	30	80	70	200	15	161	130	75	675	510	185	197	116	160	125	9	413	355	160
	I-356	205	410	35	80	70	200	15	161	130	75	686	510	185	201	116	160	125	9	497	355	160
250	I-256	180	360	36	90	90	250	18	181	130	94	688	580	220	201	116	160	130	9	423	413	160
	I-356	280	560	41	90	90	250	18	181	130	94	742	580	220	205	116	160	130	9	505	413	160
350	I-356	425	850	61	130	110	350	20.5	250	180	145	855	690	260	278	160	195	180	28	614	613	230
	II-506	800	1600	64	130	110	350	20.5	250	180	145	910	690	260	278	160	195	180	28	644	613	230
	II-806	1450	2300	65	130	110	350	20.5	250	180	145	952	690	260	291	160	195	180	28	659	613	230
450	II-506	875	1750	88	170	160	450	23	300	220	190	1048	800	310	336	165	195	190	29	728	724	270
	III-1306	2000	4000	110	170	160	450	23	300	220	190	1078	800	310	360	165	195	190	29	803	724	270
	II-806	1250	2500	131	170	160	450	23	300	220	190	1142	800	310	383	165	195	190	29	833	724	270
530	III-1306	1925	3850	151	195	180	530	25	355	240	235	1143	940	365	396	190	240	240	23	833	823	290
	III-2006	3250	6500	153	195	180	530	25	355	240	235	1144	940	365	381	190	240	240	23	844	823	290
	III-1306	2100	4200	242	195	180	530	25	355	240	235	1174	940	365	394	190	240	240	23	947	823	290
600	III-2006	5800	6950	244	210	190	600	28	400	254	272	1207	1150	460	424	230	240	290	22	947	929	310
	III-3006	5800	9150	246	210	190	600	28	400	254	272	1204	1150	460	424	230	240	290	22	949	929	310
	III-3012	-	-	260	210	190	600	28	400	254	272	1327	1150	460	424	230	240	290	22	957	929	310
	III-2006	4275	8550	328	210	190	600	28	400	254	272	1372	1150	460	470	230	240	290	22	1084	929	310
750	III-3006	5650	11300	329	230	210	750	31	475	290	338	1371	1280	510	470	255	240	330	34	1084	1071	350
	III-3012	-	-	343	230	210	750	31	475	290	338	1540	1280	510	504	255	240	330	34	1084	1071	350

Friction coefficient $\mu=0,4$. Dimension values are in mm.

OPTIONS

1. Automatic lining wear adjustment (RA).
2. Mechanical or inductive open brake switch indicator (CSA).
3. Lining wear indicator (DD).
4. Hand release lever (DM).
5. Descent valve (VD).
6. Special paint (PE).
7. Reduced torque (PR).
9. Hydraulic or pneumatic release.
10. ATEX certificate.
11. Special bolts (stainless steel, galvanized).
12. Thrustor's stroke linear detector (DL).
13. Braking speed regulation cylinder.

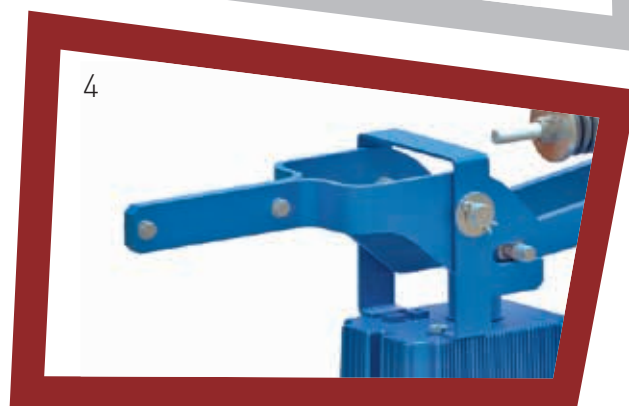
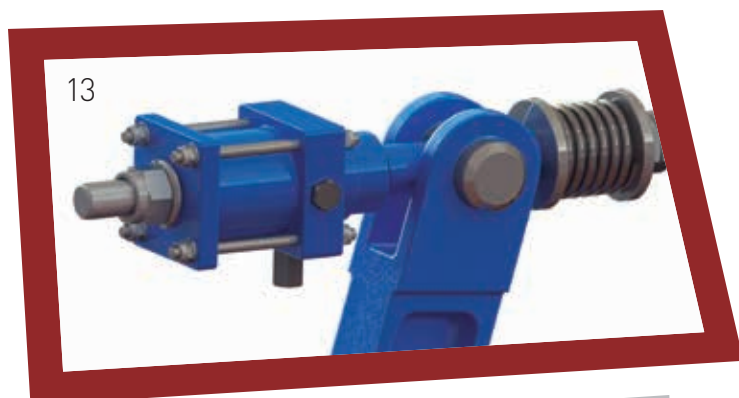
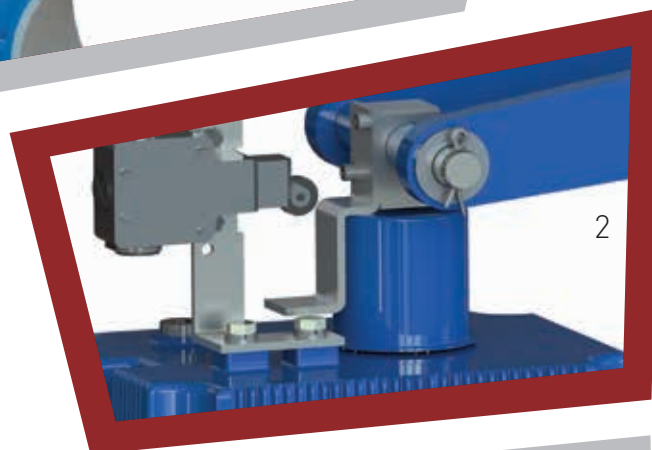
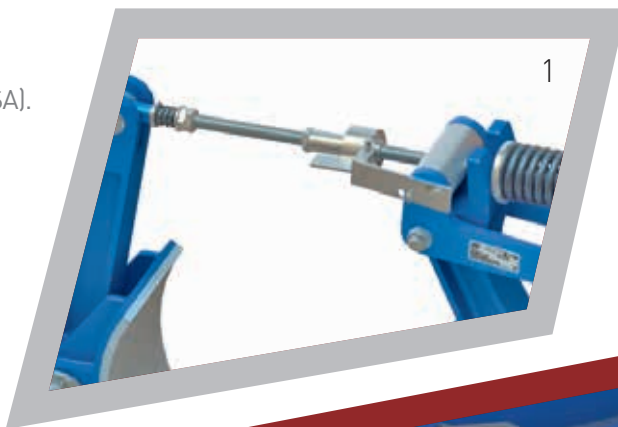

For further information about options, please contact the Antec Sales Department (sales@antecsa.com)



ANTEC SPAIN (Headquarters)

Aplicación Nuevas Tecnologías Antec SAU.

Ramón y Cajal, 74. 48920.
Portugalete. (Vizcaya) SPAIN

Tel.: +34 94 4965011
Fax: +34 94 4965337

sales@antecsa.com
antec-group.com

ANTEC CHINA

Antec Braking Systems Co. Ltd.

No.4, Longhuai Road,
Shuangjiang Dao South
Beichen Development Area
300400 Tianjin, CHINA.

Tel.: +86 22 26983272
Fax: +86 22 26983273

info@antec-bs.com
antec-group.com

ANTEC BRAZIL

Antec Eolica Fabricação e Comercio
de Freios Ltda.

Rua do Bronze (Antiga Rua H) S/N,
Quadra 43, Lote 080,
Polo de Apoio Camaçari,
Bahia CEP: 42801-170, BRAZIL.

Tel.: +55 71 36229316
info@anteceolica.com
antec-group.com